

This information is confidential and proprietary to ZAWARD. And shall not be reproduced or further disclosed to anyone other than ZAWARD employees without prior written consent from ZAWARD. Any uncontrolled printed copy of this document is for reference purpose only unless expressly authorized by ZAWARD. Authorization must include number and revision.

08015 : 80*80*15(3.15"*3.15"*0.59")

| REVISIONS | | |
|-----------|-----------------|-----------|
| REV. | DESCRIPTION | DATE |
| △ | Formal Release. | 2011/3/30 |

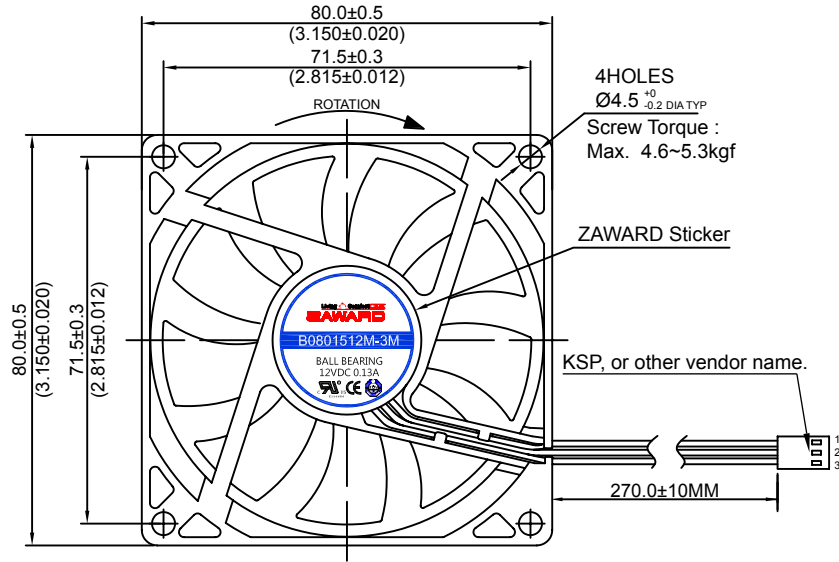
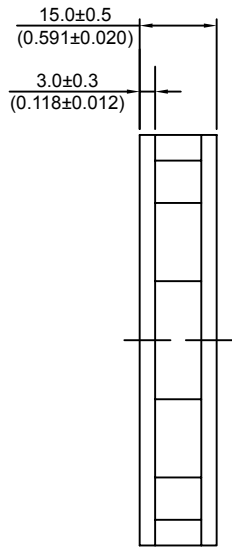

| ELECTRICAL | |
|-----------------------|------------------------------|
| Item | Specification Conditions |
| Rated Voltage | 12 VDC |
| Operating Voltage | 6~13.8 VDC |
| Starting Voltage | 6.0 VDC |
| Consumption Current | 0.13 Max. Amp at 12VDC |
| Rated Input Power | 1.56 Max. Watt at 12VDC |
| Rated Speed | 2500 RPM±10% |
| Max. Air Flow | 32.14 Max. CFM |
| Max. Static Pressure | 2.04 Max. mmAq |
| Noise Value | 25.5 dBA |
| Operating Temp | -10°C to +70°C |
| Storage Temp | -40°C to +90°C |
| Insulation Resistance | >10MΩ |
| Dielectric Strength | 500VAC/1min, 600VAC/1sec/1mA |

| MECHANICAL | |
|----------------------|---|
| Item | Specification Conditions |
| Blade Material | Thermo plastic PBT GF 15%, Class UL 94V-0 |
| Frame Material | Thermo plastic PBT GF 30%, Class UL 94V-0 |
| Frame Type | Ribbed(4 holes) |
| Signal Output | FG Frequency Generator |
| Connection Lead Type | Terminal Connector |
| Rotation Direction | CCW Counter-clockwise viewed from inlet |
| Air Flow Direction | ETV Air exhaust through ventilator |
| Bearing Type | 2 Balls |
| Net Weight | 50.0 Gram |
| Packing | --- X --- X --- mm, 5.0kg/CTN |
| | 100 PCS/CTN |

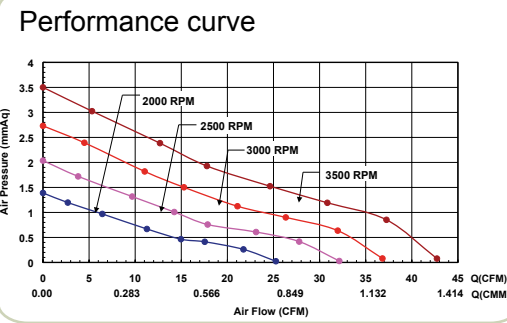

| FEATURES | |
|-------------------------|----------------------------------|
| Item | Specification Conditions |
| Locked Rotor Protection | Yes (Auto-Restart) |
| Polarity Protection | Yes |
| Life Expectancy | 70,000 Hours at 40°C 15~65% R.H. |
| Approvals | UL : E154464 , TUV : 45391 , CE |
| Functions | |

Housing drawing (SCALE :1.5:1)

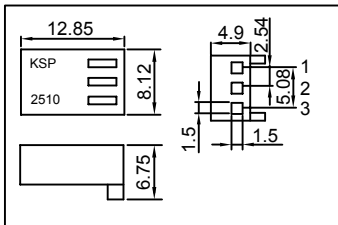

| | |
|-------------------|----------------------------|
| PIN | Function / Color |
| 1 | -GND, BLACK |
| 2 | +12V, RED |
| 3 | Signal, WHITE |
| Connector Housing | Equivalent of Molex or KSP |
| Connector Pin | 2510/22-01-3037 |

| | | | | |
|------------|--------------------|-------|--------------------|-----------|
| | | | | |
| MODEL NO. | B0801512M-3M(RoHS) | | | |
| PART TITLE | DC Axial Fan | SCALE | 1:1 | |
| SIZE | SHEET | RoHs | REFERABLE | DATE |
| A4 | 1/1 | Yes | 578111030(FS-7602) | 2011.3.30 |
| | | | | REV. |
| | | | | 0.00 |

APPROVED Carmen CHECKED Regina DRAWN Daniel VIEW mm

A B C D E F G